

# South Walter Reed Drive Complete Streets Project

---

5th Street South to Columbia Pike, Tree Exhibit  
Summer 2025



# 5<sup>th</sup> Street S to 8<sup>th</sup> Street S: Planned Tree Impacts

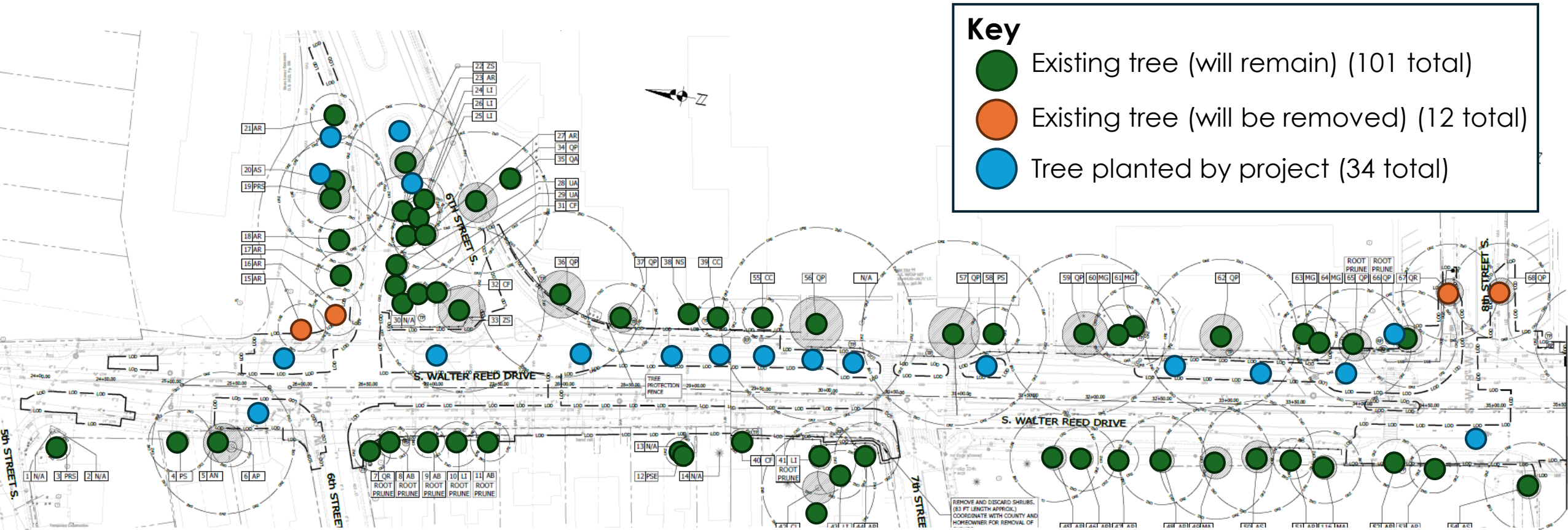

The Transportation Division team works with staff from Urban Forestry to ensure the project minimizes impacts to existing trees and plants new, tree species appropriate to the urban condition, selected from the recommended street tree species list. While the County uses standards of performance and practice to limit impact to trees, trees are living organisms with complex root systems which can be difficult to perfectly map and protect.

# 8<sup>th</sup> Street S to Columbia Pike: Planned Tree Impacts

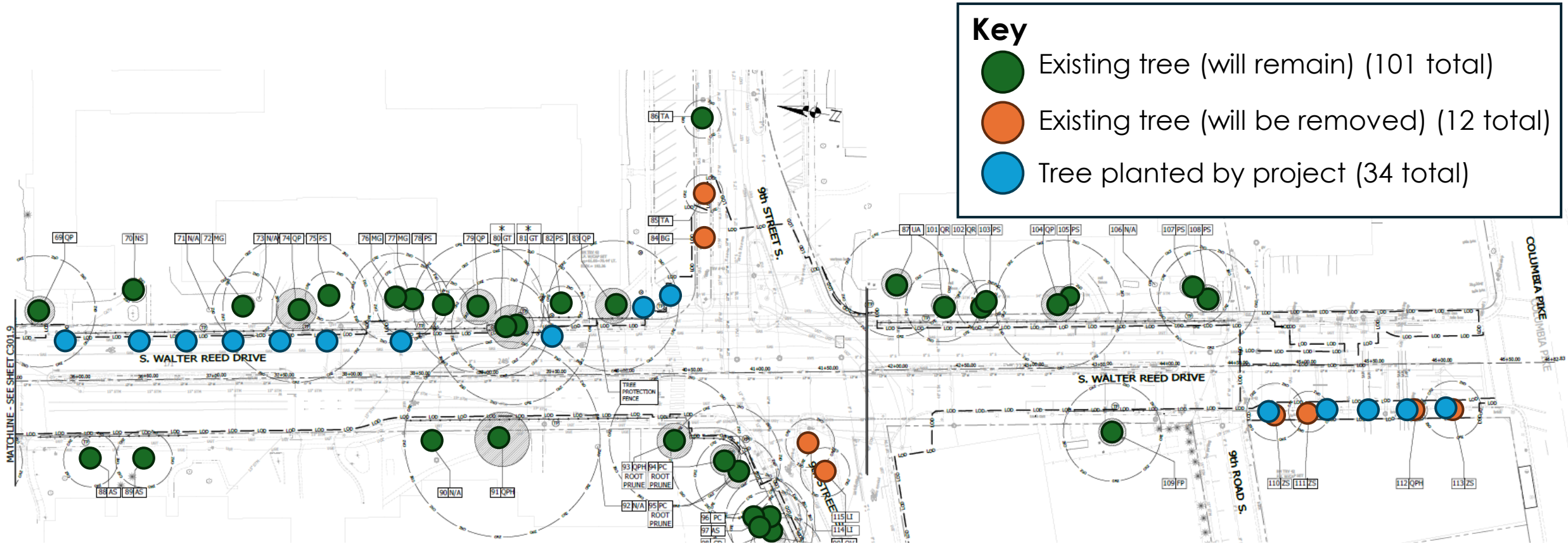

The Transportation Division team works with staff from Urban Forestry to ensure the project minimizes impacts to existing trees and plants new, tree species appropriate to the urban condition, selected from the recommended street tree species list. While the County uses standards of performance and practice to limit impact to trees, trees are living organisms with complex root systems which can be difficult to perfectly map and protect.