

REVISED ON 11/19/2021

FILENAME: B17K-230-PLAN_PROFILE-K.DWG PATH: Q:\DATA\B17K\DESIGN\CAD\ACTIVE\N KENSINGTON ST PLOTTED BY: ECACCAVARI

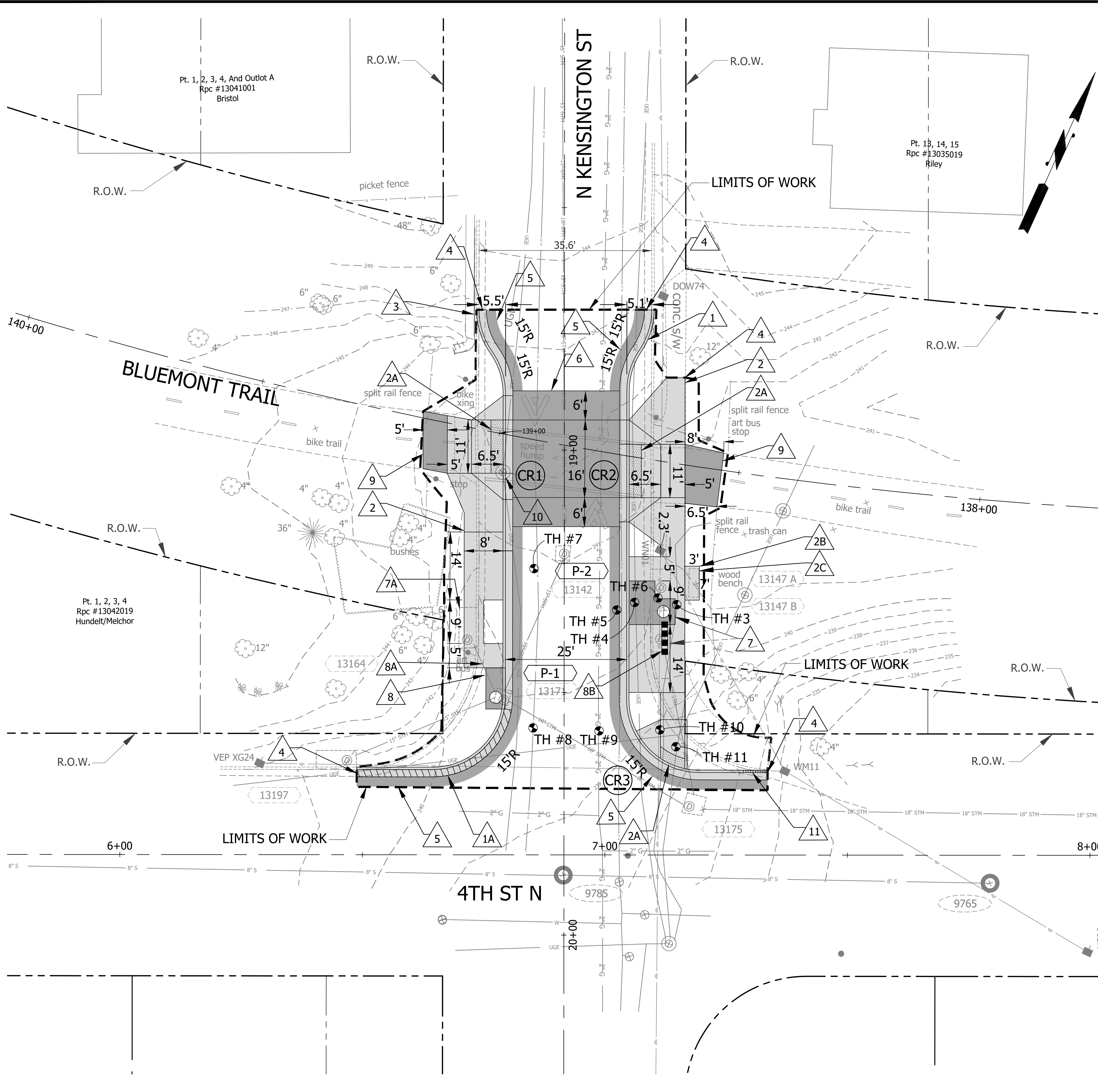

CONSTRUCTION NOTES

- 1 PROP CURB AND GUTTER (C-2) ARL STD (R-2.0)
- 1A PROP STD. REVERSE PITCH CURB (C-2R) ARL STD (R-2.0)
- 2 PROP SIDEWALK ARL STD (R-2.0)
- 2A PROP RAMP MODIFIED (CG-12A) VDOT ROAD & BRIDGE STANDARDS (204.02) SEE CURB RAMP DETAIL ON SHEET #C042.1
- 2B PROP CONCRETE PAD FOR BENCH; INSTALL NEW BENCH (BENCH PROVIDED BY OTHERS)
- 2C REMOVE EXISTING BENCH
- 3 MAINTAIN FOUNDATION OF EXISTING RETAINING WALL
- 4 MATCH EXISTING SIDEWALK AND/OR CURB & GUTTER
- 5 MATCH EXISTING ROADWAY SURFACE
- 6 PROPOSED RAISED CROSSWALK. SEE SHEET C004.1 FOR DETAILS
- 7 REMOVE EXISTING DOUBLE CATCH BASINS, REPLACE WITH MODIFIED CATCH BASIN SEE SHEET #C072.2 FOR DETAILS
- 7A REMOVE EXISTING STORM STRUCTURE
- 8 CONVERT EXISTING MANHOLE TO CATCH BASIN AND PARTIAL WALL REPAIR
- 8A REMOVE EXISTING 15" RCP STORM PIPE
- 8B PROPOSED (10') - 15" RCP STORM PIPE
- 9 MATCH EXISTING TRAIL SURFACE
- 10 MANHOLE COVER ADJUSTED TO PROPOSED GRADE (BY OTHERS)
- 11 NOSE DOWN PROPOSED CURB TO GRADE (TAPER LENGTH=5')

LEGEND

CR# CURB RAMP NUMBER
 SEE SHEET C042.1 FOR CURB RAMP DETAILS

ARLINGTON VIRGINIA
 DEPARTMENT OF ENVIRONMENTAL SERVICES
 FACILITIES & ENGINEERING DIVISION
 ENGINEERING BUREAU
 2100 CLARENDON BOULEVARD, SUITE 813
 ARLINGTON, VA 22201
 PHONE: 703.228.3629
 FAX: 703.228.3606
 COPYRIGHT © 2021 ARLINGTON COUNTY VIRGINIA - ALL RIGHTS RESERVED

SEAL

APPROVALS	DATE
QUALITY CONTROL ENGINEER	
CONSTRUCTION MANAGEMENT SUPERVISOR	
WATER, SEWER, STREETS BUREAU CHIEF	
TRANSPORTATION DIRECTOR	
PROJECT MANAGER	

REVISIONS	DATE

**BLUEMONT TRAIL
PLAN AND PROFILE**

DESIGNED: E CACCAVARI
 DRAWN: E CACCAVARI
 CHECKED: J LIN
 PLOTTED: MARCH 14 2022

